

TRAXXON

SBH-15: 360° POSITIONER & DRILLING BOOM

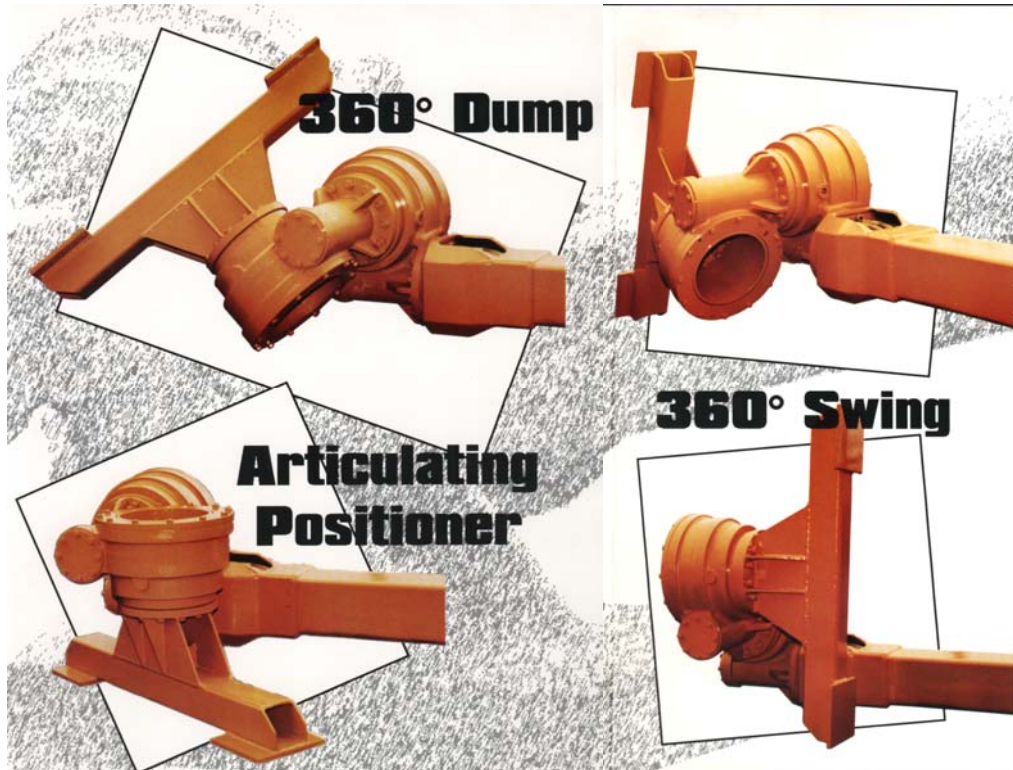

The Traxxon SBH-15 Boom Head consists of two identical, self locking worm drive gearbox assemblies. The gearboxes are designed in such a way as to allow them to be coupled to each other to provide rotation in two perpendicular planes. Independent hydraulic motors power each rotation. The hydraulic motors are located on the mounting flanges of the gearboxes and are shielded by the structure or gear that the rotation housing is mounted to.



Drilling boom with SBH-15 swing and dump positioners mounted on a Traxxon tracked surface drill.



SBH-15 swing positioner mounted on a Traxxon excavator drill package.



Traxxon fully articulating probing drill boom with SBH-15 positioners and 360° pedestal mounted on a tunnel boring machine.

SPECIFICATIONS: SBH-15 BOOM HEAD

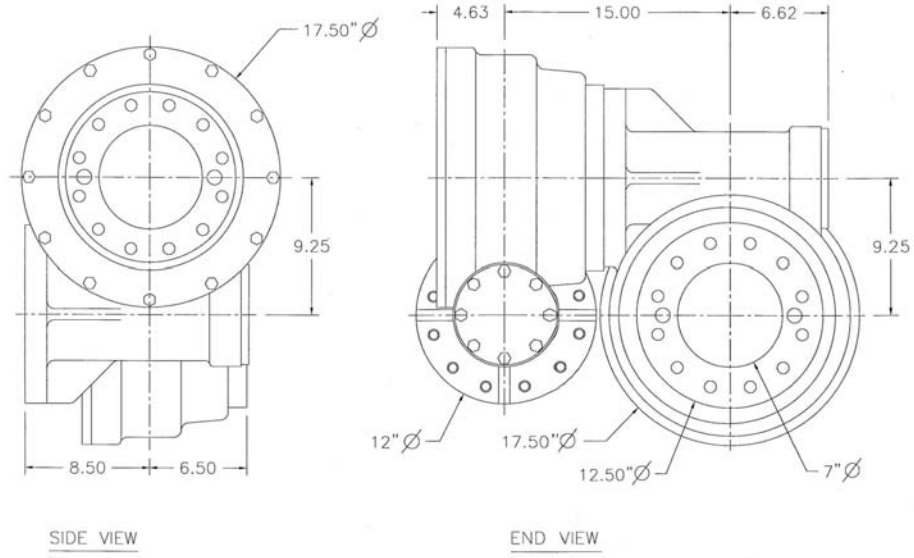

Moment Torque - Dump & Swing: 12,000 ft.-lbs
 Weight (double actuator assembly): 850 lbs.
 Mounting Flange: 12ea 3/4" N.C. on a 10.00"
 B.D.C. Hydraulic Pressure Required: 2250 P.S.I.